



ASSEMBLY INSTRUCTIONS – HALLOWEEN HAUNTED HOUSE

Your kit will come as flat pack pieces. You can paint, decorate or line the parts before assembly but avoid getting anything in the joints or assembly will be difficult.



This version of the Halloween Haunted House includes gothic arched window frames and an optional front door. The gravestones can be arranged to suit and will fit into any of the gravestone slots. The fence can be glued in straight, wonky or with bits broken off to create a more derelict appearance. We hope you have fun putting this kit together!

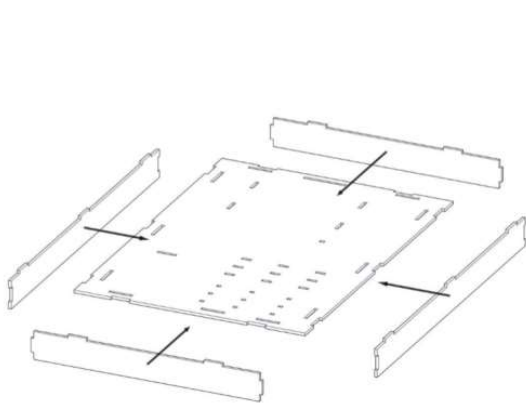

Figure 1

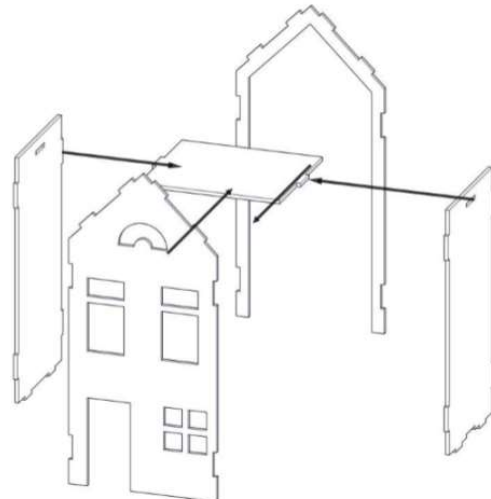

Figure 2

Figure 1 – Ensuring good sides are always facing out, assemble the base.

Figure 2 – Glue and slot the house panels together – front, sides, ceiling and back opening.

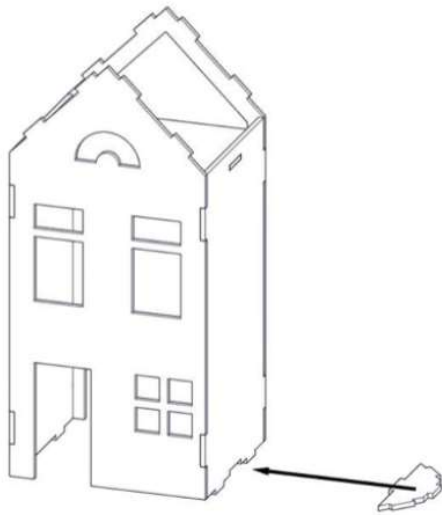

Figure 3

Figure 3 – Glue in the foundation piece for the alcove.

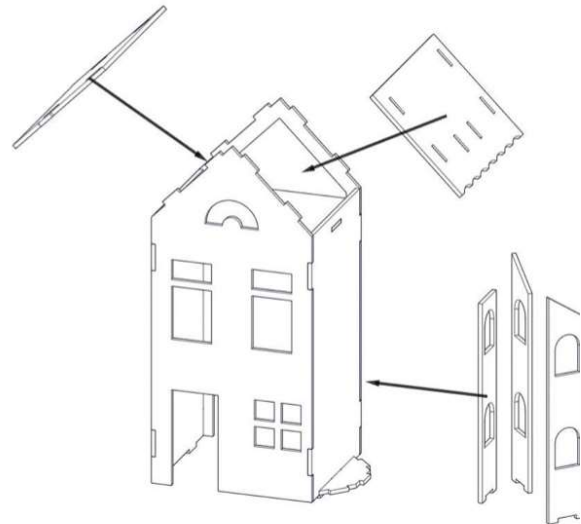

Figure 4

Figure 4 – Attach the two roof pieces and glue on the 3 alcove panels.



Figure 5

Figure 5 – Main house assembled.

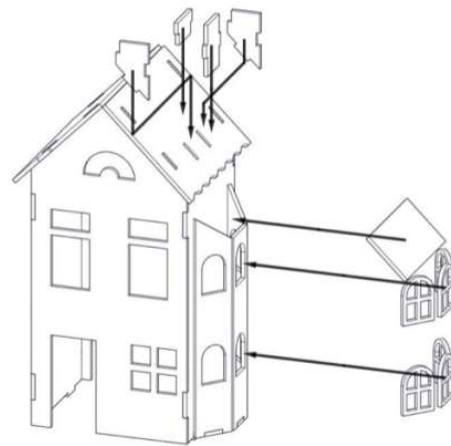

Figure 6

Figure 6 – Slot and glue together the 4 chimney pieces and add these to the roof. Glue the roof piece onto the house alcove, add the window frames.



Figure 7

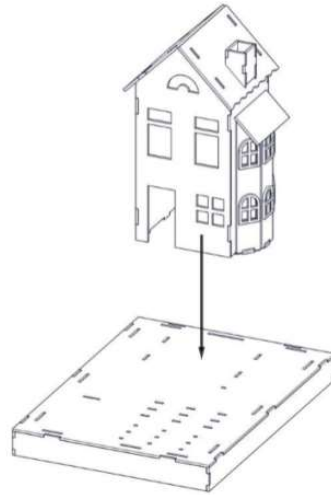

Figure 8

Figure 7 – Main house with alcove, roof and chimney assembled.

Figure 8 – Glue the house into the base.

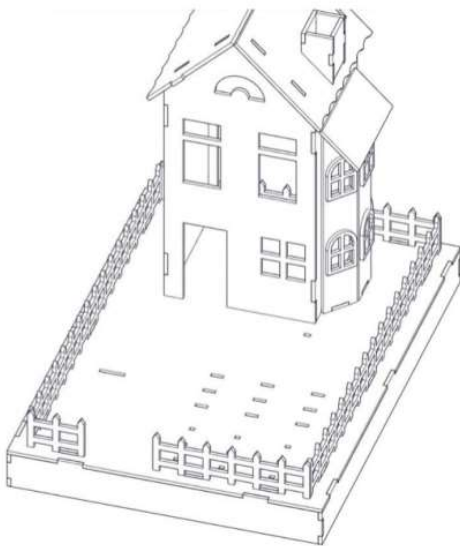

Figure 9



Figure 10

Figure 9 – Glue and slot in the fence pieces.

Figure 10 – Add the main house window frames – front door is optional. Glue and slot in the haunted tree, gravestones and ghost if you wish to use them.

HINTS & TIPS

Always use a good quality wood glue. You may find low tack masking tape useful to hold things together while drying. Make sure you wipe away any glue oozes immediately with a damp cloth.

You can use battery operated tea or fairy lights with this house kit - DO NOT use any candle with a naked flame!