



ASSEMBLY INSTRUCTIONS – HALLOWEEN COBWEB HOUSE



Your kit will come as flat pack pieces. You can paint, decorate, or line the parts before assembly but avoid getting anything in the joints or assembly will be difficult.

The base pieces come with a hole – you can use this to insert and access battery operated fairy lights or candles to add a spooky atmosphere! Do not use with naked flames!

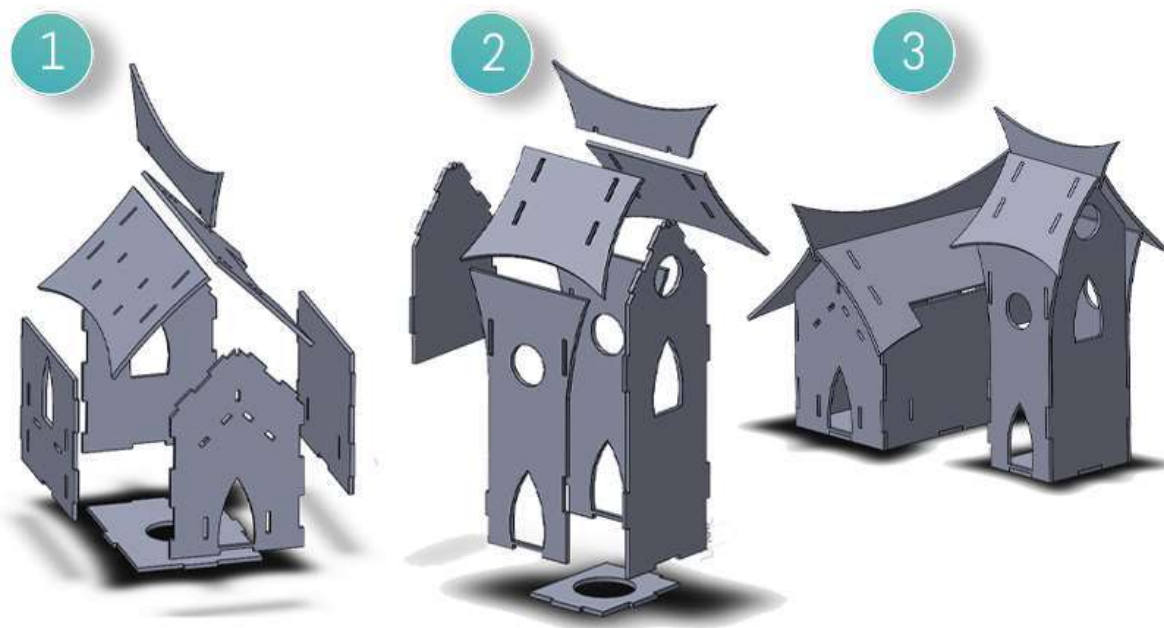

1. Ensure that good sides are facing out, assemble the main house walls onto the base piece. Add the roof pieces and top with the matching length topper piece.
2. Assemble the tower following the same method.
3. Add the tower to the main house.

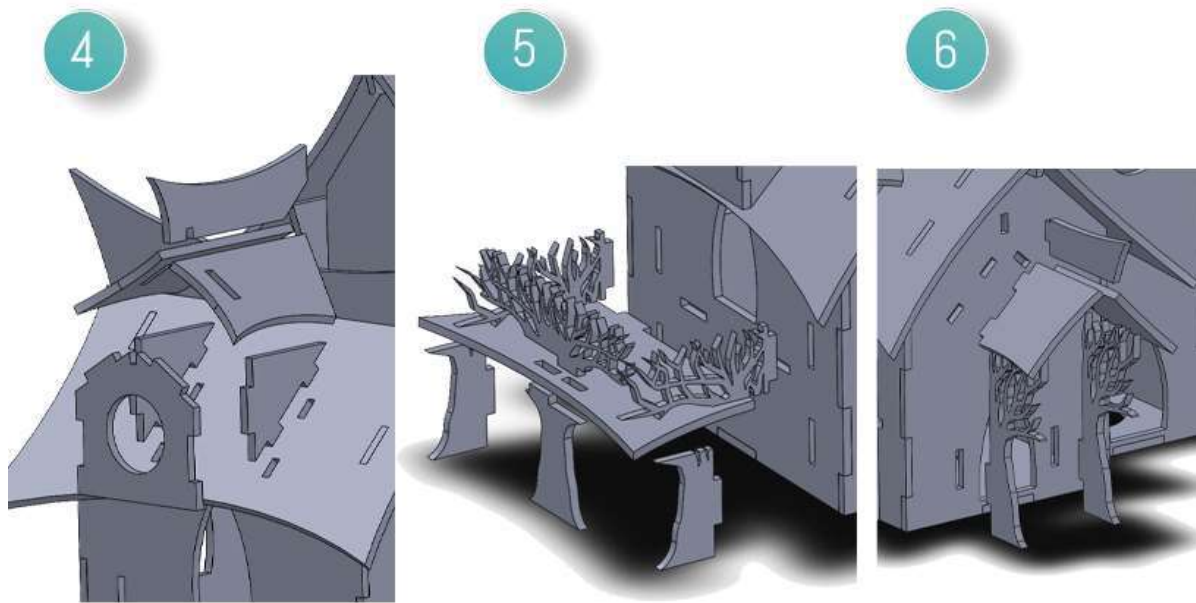

4. Assemble the dormer window by inserting the 2 support pieces into the roof, add the front window piece, the 2 roof pieces and add the matching topper piece.
5. Assemble the balcony by inserting the 3 tree trunk pieces under the balcony floor, insert the tree branches in place to create the balcony surround, then click into place on the main house building.
6. Assemble the front porch by inserting the 2 trees onto the main house, add the 2 roof pieces and add the matching topper piece.

Use the photographs of the finished piece as a guide to where to put the cobweb embellishments – you can use any, none or all of these to create the look you prefer.

And that's it! We hope you have enjoyed putting your kit together.

HINTS & TIPS

Doing a “dry run” assembly first (no glue!) can help with knowing what should go where! Always use a good quality wood glue. You may find low tack masking tape useful to hold things together while drying. Make sure you wipe away any glue oozes immediately with a damp cloth.